

MARTIN FOUNTAIN **USER MANUAL**

3002248

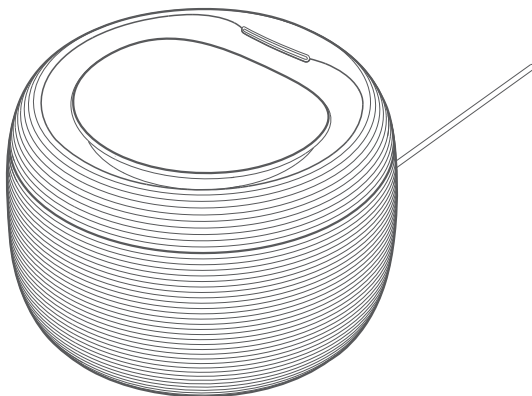

NOTICE



Please Read The User Manual Carefully
Before Use and Keep It in A Safe Place!



Explanation of Attention Words and Symbols



This is the safety alert symbol. It is used to alert you to potential personal injury hazards. Obey all safety messages that follow this symbol to avoid possible injury or death.

WARNING

WARNING indicates a hazardous situation which, if not avoided, could result in death or serious injury.

CAUTION

CAUTION, used with the safety alert symbol, indicates a hazardous situation which, if not avoided, could result in minor or moderate injury.

CAUTION

CAUTION, without the safety alert symbol, is used to address practices not related to personal injury.

NOTICE

NOTICE is used to address practices not related to personal injury.



PROHIBITED indicates that the operation is prohibited.



EXCLAMATION MARK some information that requires additional attention.



Safety Instruction for This Product

⚠ WARNING

This product is not recommended for pets under 3 months old.



⚠ CAUTION

This product is a low-voltage product, but pets biting on the cable will still cause electrical leakage. Please guide your pets properly.



If the water in the product is not consumed for a long time, the water must be changed in time. Please make sure the pet's drinking water is clean, non-toxic and harmless.



CAUTION

Keep it level and do not knock over the product, otherwise it will cause the equipment to malfunction or spill water.



This product can only filter drinking water, please do not place other pet beverage products or other non-pure water liquids in the fountain.



When the product contains water, the indoor ambient temperature cannot be lower than 0°C (33.8 F). Otherwise, freezing will damage the product.



NOTICE

This product is forbidden to be washed in a dishwasher.



What's in The Box

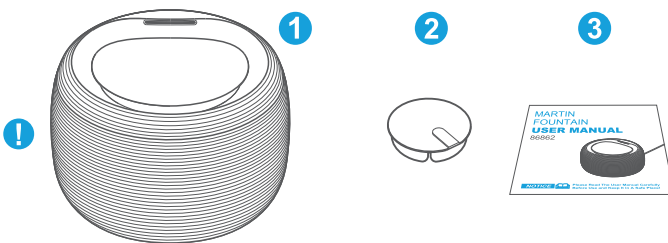

1. MartinFountain 1
2. Filter 1
3. Quick start card 1

Including silent water pump, silent sponge and aqueduct.



Introduction of Components

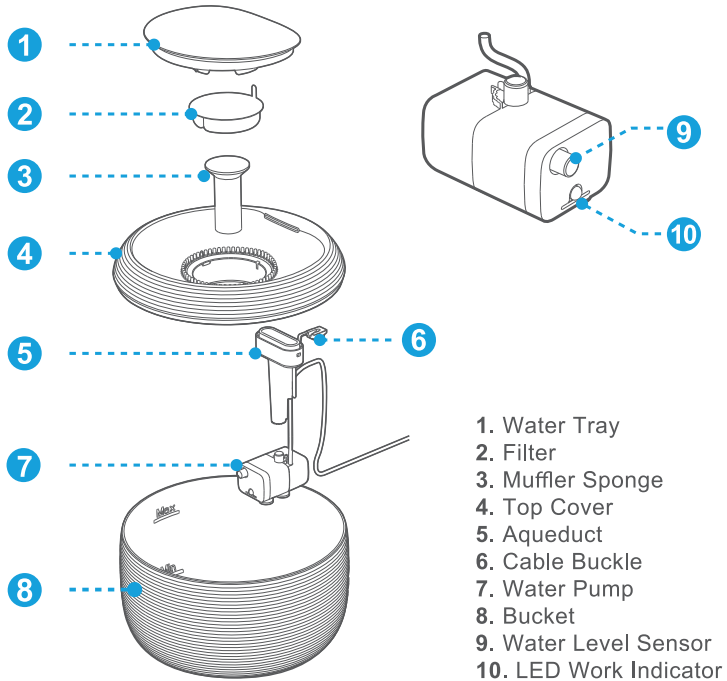



Introduction of Components

NOTICE



When the product contains water, the indoor ambient temperature cannot be lower than 0°C (33.8 F). Otherwise, freezing will damage the product.

1. Take out the filter, muffler sponge, and pump filter sponge, and rinse them. Notice : The filter element needs to be rinsed before use to wash off the activated carbon powder.

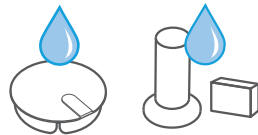

NOTICE: Double-Touch to switch the working mode; Long-Touch to manually flush hair.

2. Lift the water tray with fingers along the edge of the water tray, first put in the muffler sponge, and then place the filter face up in the filter compartment.

3. You can take the entire fountain to the water source to collect water, or only the bucket to collect water. Fill the bucket to the maximum water level with water.

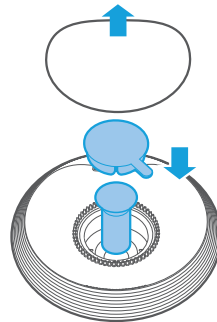

CAUTION

Do not use hot water above 46°C (114.8 F). Only for household tap water or bottled drinking water.

- Put the top cover on the bucket. Insert the USB terminal into any USB port and fix the power cable to the bottom of the bucket.

CAUTION

The input USB voltage of this product is 5V. Please check the output voltage of your power supply and adapter type carefully.

- When the water level is lower than the water level sensor, the LED light of the water pump will continue to flash, prompting to add water.bucket.

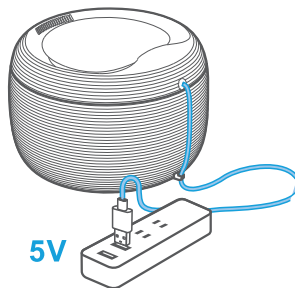
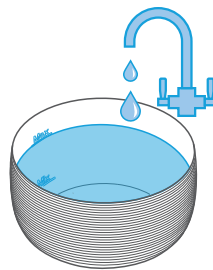



Maintenance

1. Filter life cycle

The service life of the filter element will be different according to the specific usage and the quality of the water source. It is recommended to replace after two weeks of continuous use.



2. Simple Cleaning

It is recommended to clean the bucket, filter element, and muffler sponge every time you re-fill water.



3. Full Cleaning

- Please perform a full cleaning once a month.
- After long-term use, some dirt may be built up on the surface of the internal waterway, which needs to be cleaned with a brush.
- Full cleaning requires disassembly of the product.

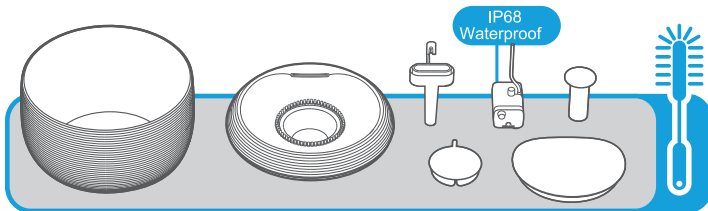

4. Maintenance of The Pump

After long-term use, the water flow may decrease or the pump may make noise. This is due to the accumulation of dirt and foreign objects inside the water pump, so it is necessary to disassemble the pump regularly for cleaning. It is recommended to disassemble and wash twice a year.

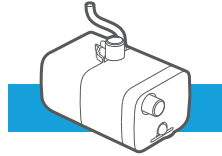

5. How to Disassemble The Pump ?

- As shown in the picture below, use a screwdriver to remove the screw to open the cover, and then take out the propeller directly. Use a small
- brush to clean the propeller and all internal surfaces of the pump. Finally assembled.

! The water pump is IP68 waterproof, dismantling and cleaning will not affect the waterproof performance.

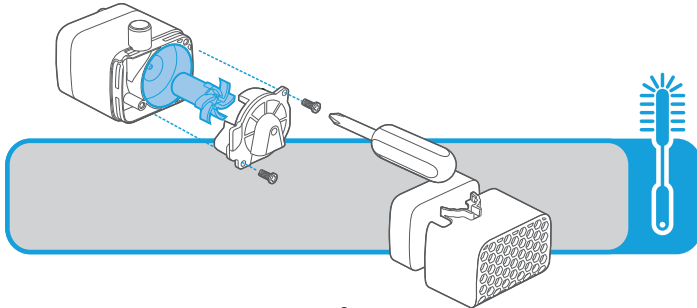



FAQ

Q Why doesn't the product work after connecting the wires?

A The USB head is not inserted all the way, please insert it again.
The power cable is broken inside, please replace with a new one.
Please check if the socket switch is turned on.

Q How long can the filter element be used?

A The service life of the filter element may be longer or shorter depending on the specific usage. It is recommended to replace it after half month of continuous use.

Q Why is there black powder floating in the water?

A This is a fine powder of coconut shell activated carbon, which is safe and harmless. You can clean the filter element separately to solve this problem.

Q Why does the pump make abnormal noise during use?

A It is possible that small foreign objects have entered the water pump.
Please disassemble and wash the water pump and reinstall the pump.



Terms of Use & Limitation of Liability

1. Terms of Use

Your use of this product means that you accept all terms, conditions and statements in this manual.

2. Correct Use

This product is designed for pets' daily drinking water. Proper use includes reviewing the entire user manual included with the product and any specific "Caution" statements.

3. Prohibition of illegal or Prohibited Use

This product is only suitable for pets. Please ensure that the water source is clean, non-toxic and harmless. Using this product not in accordance with the instruction manual may violate local laws.

4. Scope of Responsibility

The manufacturer is not responsible for any related damages, direct, indirect, punitive, non-major, and other indirect losses caused by incorrect use or abuse of this product. The buyer bears all risks and responsibilities of using this product.

5. Modification of Terms and Conditions

The manufacturer reserves the right to change the terms, conditions and notices related to this product.



Certification Statements



This device complies with Part 15 of the FCC Rules.

Operation is subject to the following two conditions:

- (1) This device may not cause harmful interference, and
- (2) This device must accept any interference received, including interference that may cause undesired operation.

Warning: Changes or modifications not expressly approved by the party responsible for compliance could void the user's authority to operate the equipment.

the party responsible for compliance could void the user's authority to operate the equipment.

Note: This equipment has been tested and found to comply with the limits for a Class B digital device, pursuant to Part 15 of the FCC Rules. These limits are designed to provide reasonable protection against harmful interference in a residential installation. This equipment generates uses and can radiate radio frequency energy and, if not installed and used in accordance with the instructions, may cause harmful interference to radio communications. However, there is no guarantee that interference will not occur in a particular installation. If this equipment does cause harmful interference to radio or television reception, which can be determined by turning the equipment off and on, the user is encouraged to try to correct the interference by one or more of the following measures:

- Reorient or relocate the receiving antenna.
- Increase the separation between the equipment and receiver.
- Connect the equipment into an outlet on a circuit different from that to which the receiver is connected.
- Consult the dealer or an experienced radio/TV technician for help.



The company declares under its own responsibility that this product complies with the basic requirements of CE (2014/30/EU) and RoHS (2011/65/EU). Without the approval of our company or the distributor, unauthorized changes or modifications to the equipment may violate the CE regulations, may cause the user to lose the right to operate the equipment, and invalidate the warranty.



Recycling Information

Please observe the regulations for electronic and electrical devices to be disposed of in the respective country. In some countries or regions this device must be recycled. If this device is no longer required, it must not be disposed of with normal municipal waste. For more recycling information, please refer to local regulations.



Material execution standards

The main materials of the product are all BPA-free materials.



Specifications

Product name: Martin Fountain

Model number: 3002248

Input voltage: 5VDC

Rated power: 1W

Working current: 200mA

Material: ABS

Product capacity: 2.5L (84.5 fl oz U.S.)

Product size: 21cm*21cm*15cm(8.3in*8.3in*6in)

Operating temperature: 1 C~40 C (33.8 F~132 F)

Storage temperature: -10 C~50 C (14 F~122 F)/No water

Scope of application: cats and medium/small dogs



Designed and manufactured
in China

 martin®